

Middle Lake

Approximate Water Elevation
on September 26, 2017, = 66.8

Plat of Survey

of

Lot 2 in Block 1 of Cool Hill Park,

a subdivision located in the Northwest 1/4 and the Northeast 1/4 of the Southwest 1/4 of
Section 35, Town 4 North, Range 16 East, Town of LaGrange, Walworth County, Wisconsin.

Surveyed for:

Alice Wylie

W5564 Black Foot Circle
Elkhorn, Wisconsin. 53121

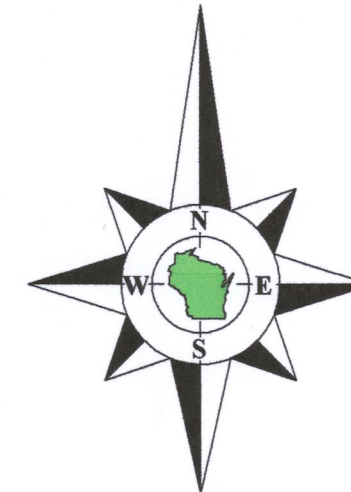

Bearings referenced to the Southerly line of Lot 2,
recorded as S55°00'E on the plat of Cool Hill Park.

Lot 2
Tax Parcel
HCH 00002
0.494 Acre
21,538 Sq.Ft.

Lot 1

Lot 3

Benchmark
Mag Nail in Asphalt
Elevation = 100.00,
assumed.

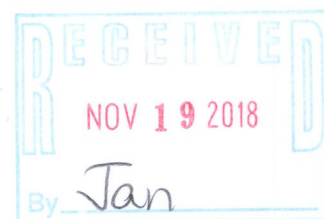
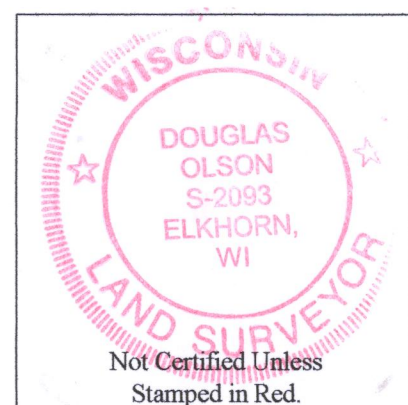

Copyright ©2018 by Olson Land Surveying, LLC.

All rights reserved. No part of this survey plat may be reproduced or transmitted in any form by any means - graphic, electronic, or mechanical, including photocopying, tracing, or information storage and retrieval systems - without permission in writing from Douglas G. Olson, Olson Land Surveying, LLC.

I hereby certify that I have surveyed the above described property in compliance with Chapter A-E 7 of the Wisconsin Administrative Code and that the map hereon is correct to the best of my professional knowledge and belief and shows the size and location of the property, its exterior boundaries, the location and dimensions of all visible structures thereon, boundary fences, apparent easements and roadways and visible encroachments, if any.

This survey is made for the exclusive use of the present owners of the property, and also those who purchase, mortgage or guarantee title thereto, within one year from the date hereof.

Douglas G. Olson
Wisconsin Professional Land Surveyor - 2093

Notes:

- 1) This Plat of Survey is not certified unless signed and sealed in red ink.
- 2) This survey is subject to Wisconsin lien laws. This Plat of Survey is the notice of intent to file lien. Lien waiver required.
- 3) The Survey Date shown on this Plat of Survey is the completion date of the field work.

Survey Date: September 26, 2018.
Revisions:

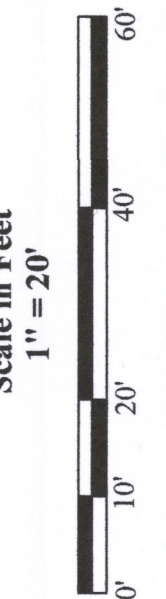

45 South Wisconsin Street | P.O. Box 322
Elkhorn, Wisconsin. 53121
Telephone: (262) 723-3434
Facsimile: (262) 723-8044
Email: doug@olsonsurveying.com
Website: www.olsonsurveying.com

OLSON
LAND SURVEYING, LLC
Rural | Residential | Commercial

Legend of Symbols & Abbreviations
Found Iron Pipe
Rebar
Utility Pole
Utility Pedestal
Concrete Cover
Septic Vent
Asphalt Surface
Concrete Surface
Stone Surface
Brick Pavers
North
South
East
West
In Bearings
In Degrees
In Minutes
In Seconds
In Feet
In Inches

Sheet 1 of 1 Sheets
Drawing Name:
Job Reference Number
2018.137

2018.137

HCH-2 416-3058